

# IP TEST KIT™ IP LUMINAIRE SEALING TEST MANUAL

## 1. CAUTION

- Ensure the unit to be tested is physically disconnected from the power
- Place the unit to be tested and the IPTEST KIT on a stable and plane surface for working service.

## 2. WARNINGS

- Before performing any operation, be sure to have completely read and understood all related instructions, including the preliminary and final steps involved ;

## 3. REQUIRED TOOLS

- 14 spanner
- User manual
- Goretex valve key socket wrench ( included on the kit)

## 4. BACKGROUND



## 5. PROCEDURE

### 5.1 Procedure



Open the case and check that all accessories are included on the IP TEST KIT case according with the user manual

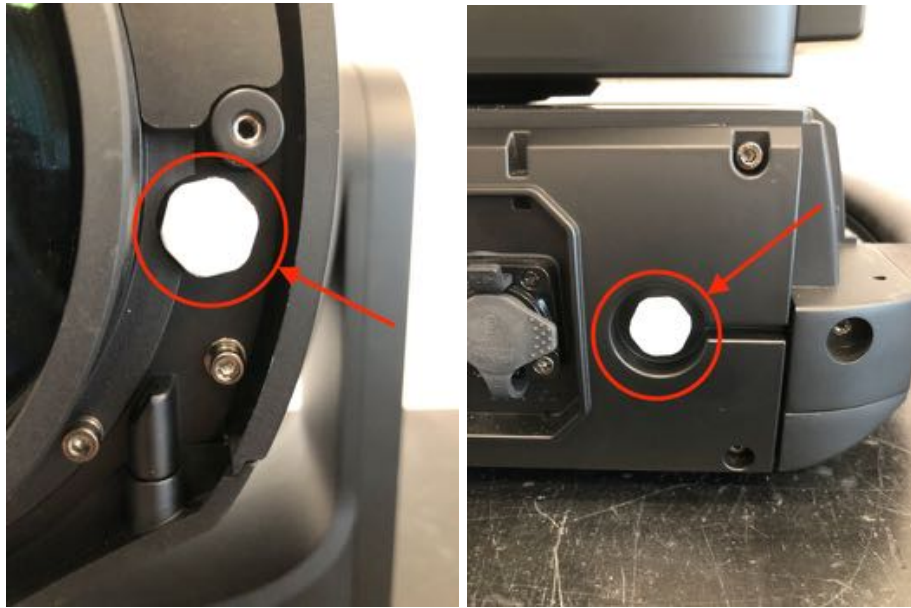

Locate the Goretex valves (2), one close to the lens, the other on the unit base.  
Remove the plastic cover if necessary.

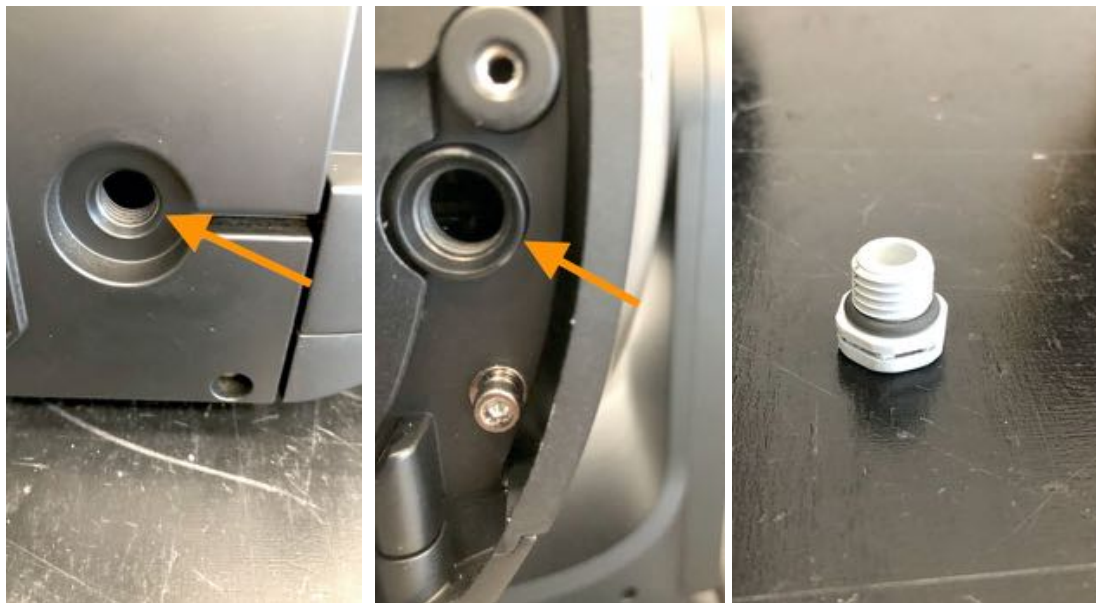

Remove both Goretex valves from the IP fixture.



Screw the ended plug into one of the two valves position.  
Plug the spiral pipe quick connector on the Vacuum/pressure Valve.



Connect the main power cord and press the ON button..





Select the requested test mode using the keyboard pad.



Select the right IP Ayrton fixture thru the list and press START.

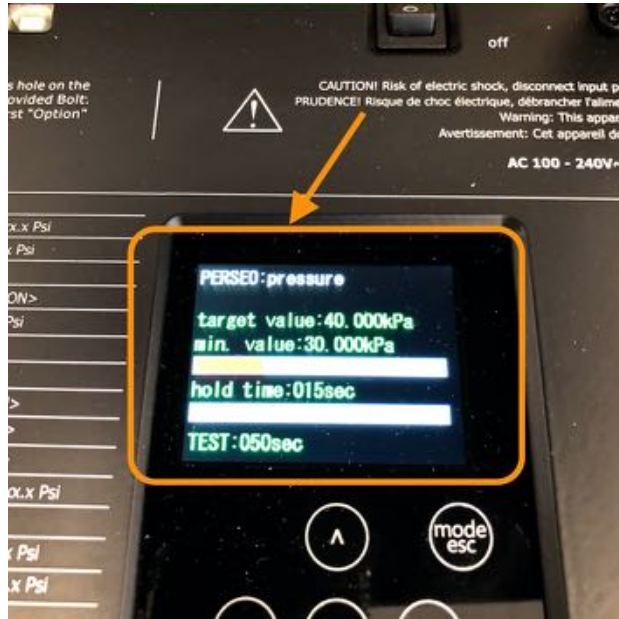

Wait for the complete stop testing process.

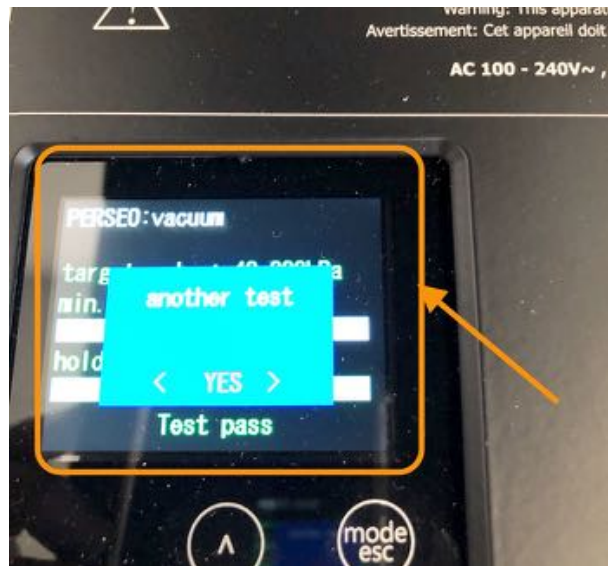

If the IP unit pass the sealing test, unplug the IP TEST KIT.

☐ In case of test failure, check the IP unit and fix it before running a second test procedure.

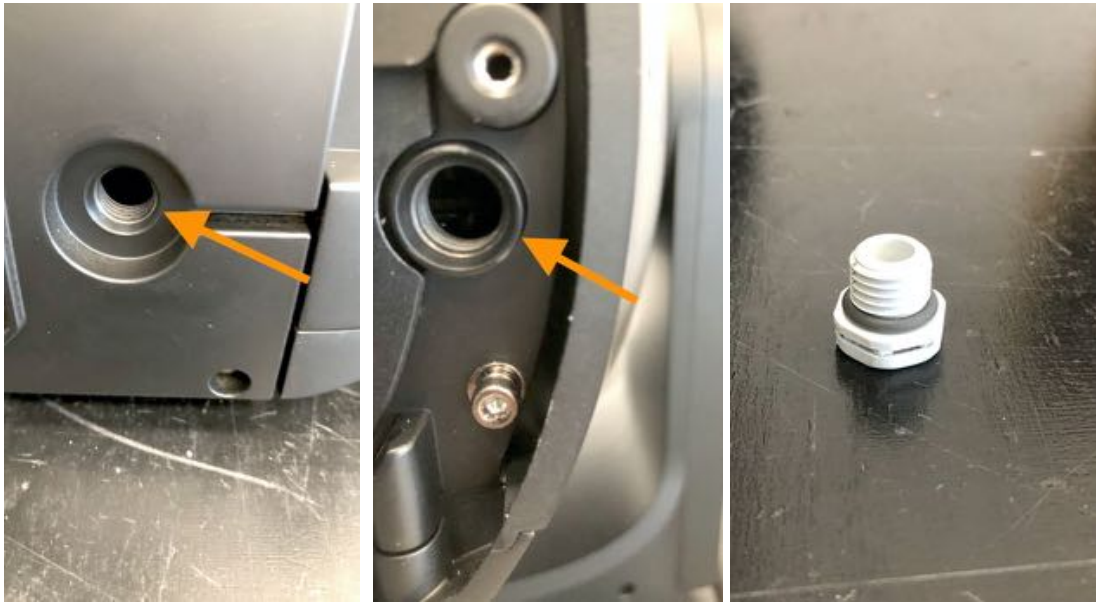

Set back both Goretex valves on the IP unit tested with the included Goretex valve key socket wrench

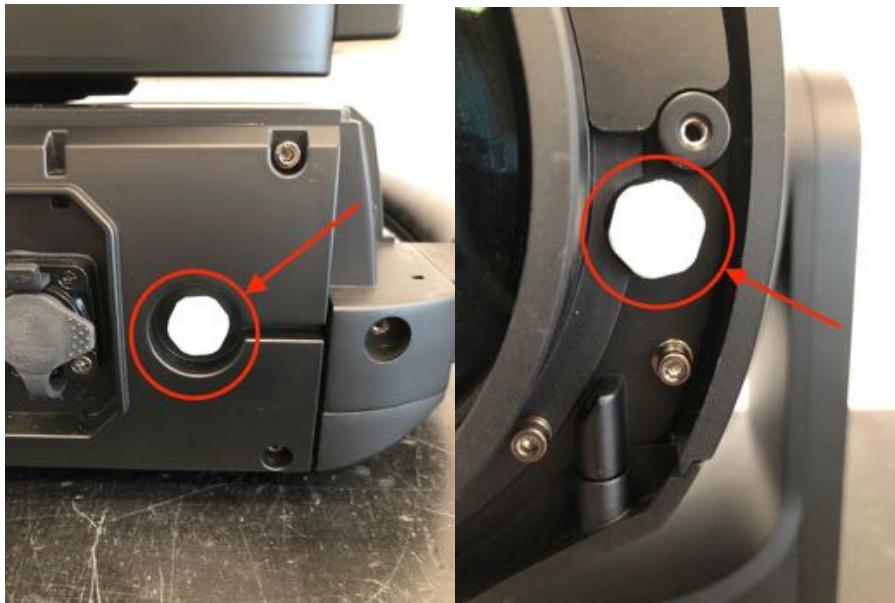



Place the spiral pipe and accessories in the compartment provided

Test the IP fixture tested and ensure that all functions are working fine.