

# ICECOLOR 250



**AYRTON**  
Digital Lighting

# ICECOLOR 250 STATIC LUMINAIRES

ICECOLOR™250 is a compact luminaire equipped with 20 x 10 Watt RGBW LED which allow the creation of an infinite palette of rich pastel or saturated colours.

Available with a wide range of optionnal holographic filters, the ICECOLOR™250 provides the perfect answer when compromise on precision and efficiency is not an option. It is equally suited to producing fabulously smooth cyclorama coverage with the addition of an 80° filter as it is to long-throw applications which it performs, without filter, using its native 11° beam angle, with many options in between.

Fitted with an ultramodern fanless cooling system based on heatpipe technology, ICECOLOR™250 can be integrated seamlessly into any environment where absolute silence is a must.



Since its original design ICECOLOR™250 has been developed for intensive indoor and outdoor use in harsh environments and in all weather conditions. The LED cooling system dictates the structure of the product with the LED, the electronic control and the power supply each integrated into individually sealed compartments that allow better air and / or water flow through the radiator.

ICECOLOR™250 respects the environment thanks to its high optical efficiency of more than 85%. This enables it to produce an overall lighting flux in excess of 5,000 lumen from a power consumption of only 200 Watt.

The total silence with which it operates, its infinite colour options and large choice of beam angles make the ICECOLOR™250 the ideal projector for 21st-century settings.







## OPTICS

- Beam aperture: 11°
- 85% optic efficiency
- Highly efficiency 45 mm PMMA optics
- Beam aperture can be modified using dedicated AYRTON optic filters

## LIGHT SOURCE

- 20 multi-chip 10 Watt LED sources
- Light output: up to 5,000 lumen
- Luminous intensity: 150,000 cd
- Rated sources life: up to 25,000 hours
- Flicker free sources management, suitable for TV applications and all video recorded events

## COLOURS

- Sophisticated 4 colours RGBW mixed, reaching high Colour Rendering Index
- Uniform light beam with no colour shadows, and rich saturated and pastel colour-hues
- 4.29 billion colours (8 bit resolution)
- Virtual colour wheel, including most usuals white colour temperature presets
- Dynamic colour macro effect with variable speed

## FROST / DIFFUSION

- Optional VNSP (Very Narrow Spot 13°), NSP (Narrow Spot 24°), MFL (Medium Flood 33°), WFL (Wide Flood 42°), VWFL (Very Wide Flood 60°) or UWFL (Ultra Wide Flood 80°) circular beam filters available
- Optional 33°x13°, 62°x16°, horizontal or vertical models elliptic beam filters available

## DIMMER / STROBE

- Electronic dimmer, allowing perfect light adjustment from 0 to 100% without colour variation
- White or colour strobe effect, with speed adjustment from 1 to 25 flashes per second

## SOFTWARE FACILITIES

- Local DMX addressing of the luminaire and its optional parameters through its built-in LCD panel control
- Remote DMX addressing of the luminaire and its optional parameters through a standard RDM DMX controller
- Constant colour system, whatever the internal/external temperature conditions
- 2 light modes, optimized for architectural or entertainment applications
- Built-in pattern effects with speed and fade controls for scenic applications
- Information menu including hour counter, temperature, software version

## HARDWARE FACILITIES

- Graphic LCD display for addressing and special functions settings, with flip function
- 5 menu buttons to set the functions
- Over temperature protection
- DMX 512 Input / Output through waterproof lockable connectors
- Waterproof lockable connectors to XLR5 connectors DMX adapters (IN / OUT) included
- Power supply input through waterproof lockable connector
- Adapter cable for waterproof lockable connector included

## CONTROL

- DMX 512 protocol, through DMX cable
- Stand-alone mode and Master/Slave modes
- DMX RDM compatible
- Local control panel with LCD display
- Choice of 6 DMX modes (from 4 to 16 DMX channels)

## POWER SUPPLY

- Electronic supply with active PFC
- 110 to 240 Volts - 50/60Hz
- Power 200 Watt max

## COOLING SYSTEM

- Advanced natural convection system
- Permanent thermal regulation
- Safety protection against temperatures excesses

## HOUSING

- 2 light source modules
- Body and glass covers in die-cast aluminium
- Heatsinks in aluminium and copper, satin finish
- Double yoke in aluminium
- Front window in tempered glass
- External hardware screws in stainless steel
- IP65 protection rating (indoor and outdoor use)
- Exterior finish: black (Carbon)

## INSTALLATION

- Double yoke system, which act as a floor stand
- Several holes into the yoke, to install clamp
- 2 rotating handles, to adjust yoke

## OPERATING PARAMETERS

- Operating positions: all (device on floor or fixed to a support)
- Maximum permitted ambient temperature (Ta max): 45°C (113°F)
- Minimum permitted ambient temperature authorised (Ta min): -10°C (14°F)
- Minimum usage distance: 1.0 m (3.28 ft)

## COMPLIANCE

### EU (EMC)

- EN 55015 (2006) - EN 55015 A2 (2009)
- EN 61547 (2009) - EN 61000-3-2 (2006)
- EN 61000-3-2 A2 (2009) - EN 61000-3-3 (2008)

### EU (LVD)

- EN 60598-1 (2008) - EN 60598-2-17 (1989)
- EN 60598-2-17 A2 (1991)

## SIZE

- Product: 443 x 260 x 209 mm (l x h x d)

## WEIGHT

- Product: 12.7 KG

## PRODUCT CODES

- 025500: ICECOLOR 250 STATIC LUMINAIRE

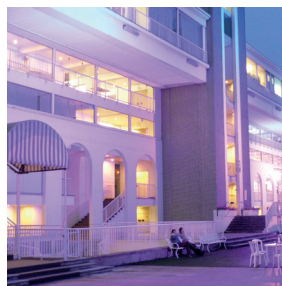
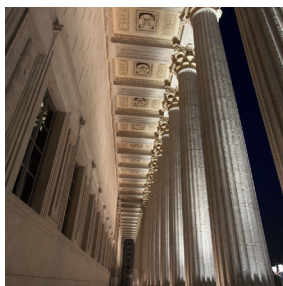



[www.ayrton.eu](http://www.ayrton.eu)